

AFN Summit 2025

Event Schedule and Program

Day 1 (Thursday 20 February)



9:00–10:00	Registrations open; Welcome coffee/tea
10:00–10:20	Summit Welcome and Acknowledgement of Country <i>Profs Sarah Hilmer & Ruth Hubbard</i>
10:20–11:15	SESSION ONE
	Consumer involvement in frailty and dementia research <i>Chair: Dr Adrienne Young</i>
	Consumer involvement: Two hats, one mission: my journey in consumer engagement <i>Dr Chandana Guha</i>
	StepUp for Dementia Research: Empowering the public through research participation and involvement <i>Prof Yun-Hee Jeon</i>
	Community action research to identify priorities for medication management resources for people with dementia and their carers <i>Dr Mouna Sawan</i>
	Q&A Session <i>Chair: Dr Adrienne Young</i>
11:15–11:40	Morning Tea
11:40–12:20	SESSION TWO
	Showcasing consumers in action <i>Co-Chair: Mr Paul Klotz</i> <i>Co-Chair: Ms Anja Christoffersen</i>
	Introducing the AFN Consumer Advisory Board <i>Mr Paul Klotz</i>
	Consumer involvement right from the very beginning: grant applications and reviews <i>Ms Diana Trickett</i>
	Consumer involvement right to the very end: research dissemination <i>Ms Elizabeth Miller</i>
12:20–12:40	Panel discussion <i>Chair: Ms Anja Christoffersen</i> – <i>Ms Peta Dampney</i> – <i>Mr Paul Klotz</i> – <i>Ms Celia Taylor</i>
12:40–1:30	Lunch; Poster display + Consumer meet & greet

AFN Summit 2025

Event Schedule and Program

Day 1: Continued

(Thursday 20 February)



	SESSION THREE
	Theoretical background and development of frailty instruments <i>Chair: Dr Benignus Logan</i>
	Clinical Frailty Scale <i>Prof Kenneth Rockwood</i>
	A Digital Frailty Index for Acute Care Settings in Queensland <i>Dr Ida Tornvall</i>
1:30 - 2:45	Developing and validating a multidomain frailty index from routine health data in older patients in six NSW hospitals <i>Dr Kenji Fujita</i>
	Optimisation of the FI using unstructured text <i>Prof Velandai Srikanth</i>
	Approaches to automated frailty index generation within Epic, an electronic medical record system <i>A/Prof Jai Darvall</i>
	FI & ACAP Administrative Data - The ROSA experience <i>Prof Renuka Visvanathan</i>
2:45-3:05	Afternoon Tea
	SESSION FOUR
	How to implement frailty measurement in your practice <i>Chair: Prof Vasi Naganathan</i>
	Designing and implementing a frailty- focused health system <i>Prof Elizabeth Whiting</i> <i>Ms Megan Kreis</i>
	A NSW Health perspective on frailty screening at the statewide level <i>Ms Kate Lloyd</i> <i>Mr Glen Pang</i>
3:05-4:25	Perioperative multidisciplinary meeting: considering frailty in the surgical patient <i>Dr Chuan-Whei Lee</i>
	Assessing for frailty using the FRAIL Scale in an acute hospital setting <i>Prof Sue Kurrle</i>
	Innovative ePRO- based frailty screening: From international evidence to local implementation <i>Dr Thilo Schuler</i>
	Approaches to Frailty in First Nations Australia <i>Dr Ebony Lewis</i>
	Incorporating clinical frailty in a routinely used measure to identify the need for palliative care in residential aged care <i>Prof Claire Johnson</i>
4:25-4:35	Day 1 Closing remarks <i>Prof Sarah Hilmer</i>
5:00	Networking drinks

AFN Summit 2025

Event Schedule and Program

Day 2 (Friday 21 February)



8:30–9:00	Registration; Welcome coffee/tea
9:00–9:05	Day 2 Opening address <i>Prof Sarah Hilmer</i>
	SESSION FIVE
	Optimising in-patient care in individuals with frailty and dementia <i>Chair: Dr Sara Fox</i>
	Keynote presentation <i>Prof Kenneth Rockwood</i>
9:05–10:25	Managing behaviours of distress <i>Dr Fred Graham</i>
	Creating supportive environments <i>Mr Nick Seeman</i>
	Creating and sustaining healthful caring cultures – a person-centred approach <i>Prof Brendan McCormack</i>
	Panel discussion <i>Chair: Dr Sarah Fox</i>
10:25–10:45	<i>Prof Kenneth Rockwood</i> <i>Dr Fred Graham</i> <i>Mr Nick Seeman</i>
10:45–11:05	Morning Tea
	SESSION SIX
	Frailty-ADD CRE Seed Grant Scheme <i>Co-Chair: Dr Kristiana Ludlow</i> <i>Co-Chair: Ms Anja Christoffersen</i>
	Introduction to Seed Grant Scheme <i>Ms Anja Christoffersen</i>
	Seed Grant Recipient 2024: Co-designing allied health clinical pathways with frail vascular surgical patients <i>Ms Katie Arnott</i>
11:05–12:15	Seed Grant Recipient 2024: Can front door frailty services deliver the same improvements to care in a setting with limited resources? <i>Dr David Carroll</i>
	Seed Grant Recipient 2025: Project exploring the role of a Frailty Clinical Champion in Australian and Swedish cardiovascular programs <i>Dr Nicola Straiton</i>
	Seed Grant Recipient 2025: Research into the economic evaluation of early frailty services in emergency departments <i>Ms Melinda Williamson</i>
	Q&A and Session wrap-up <i>Chair: Dr Kristiana Ludlow</i>

AFN Summit 2025

Event Schedule and Program

Day 2: Continued

(Friday 21 February)



12:15–12:45	Lunch; Poster display + Consumer meet & greet	
	SESSION SEVEN	
	Best abstract submissions <i>Chair: Dr Natasha Reid</i>	
	Introduction <i>Dr Natasha Reid</i>	
12:45–1:25	Using Artificial Intelligence to Predict Discharge Home in People Admitted to Hospital with Frailty: Preliminary Findings <i>Dr Jennifer Jones</i>	
	Frailty in older adults admitted to hospital: the Western Sydney Clinical Frailty Registry <i>Prof Caleb Ferguson</i>	
	Consumer and healthcare professional perspectives on deprescribing for older patients in surgical wards: A mixed methods study <i>Dr Bonnie Liu</i>	
	Session wrap-up <i>Prof Ruth Hubbard</i>	
1:25–1:30	Break into Parallel Sessions	
	Career journeys: Insights from the experts <i>Chair: A/Prof Emily Gordon</i>	The way forward for AFN consumer engagement <i>Consumer-led session</i> Level 1 meeting rooms 5
1:30–2:30	<i>Prof Cathie Sherrington</i> <i>Prof Simon Bell</i> <i>Prof Kenneth Rockwood</i> <i>Prof Yun-Hee Jeon</i> <i>Prof Brendan McCormack</i>	
2:30–2:50	Panel discussion & Session wrap-up <i>Chair: A/Prof Emily Gordon</i>	
2:50–3:00	Summit Closing remarks	
3:00–3:15	Afternoon Tea	
	SESSION EIGHT	
3:15–4:00	Career journeys: Meet the experts	

Ground Floor (Auditorium, Hands Lane & Mezzanine) Floor Plan

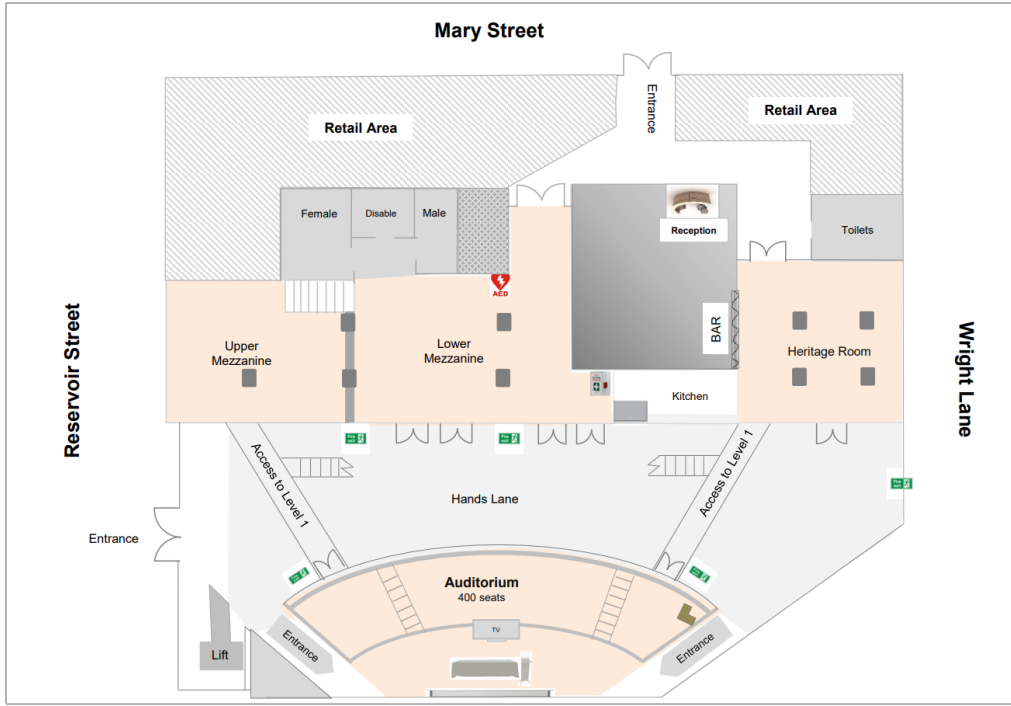

NSW Teachers Federation Conference Centre Level 1 Floor Plan

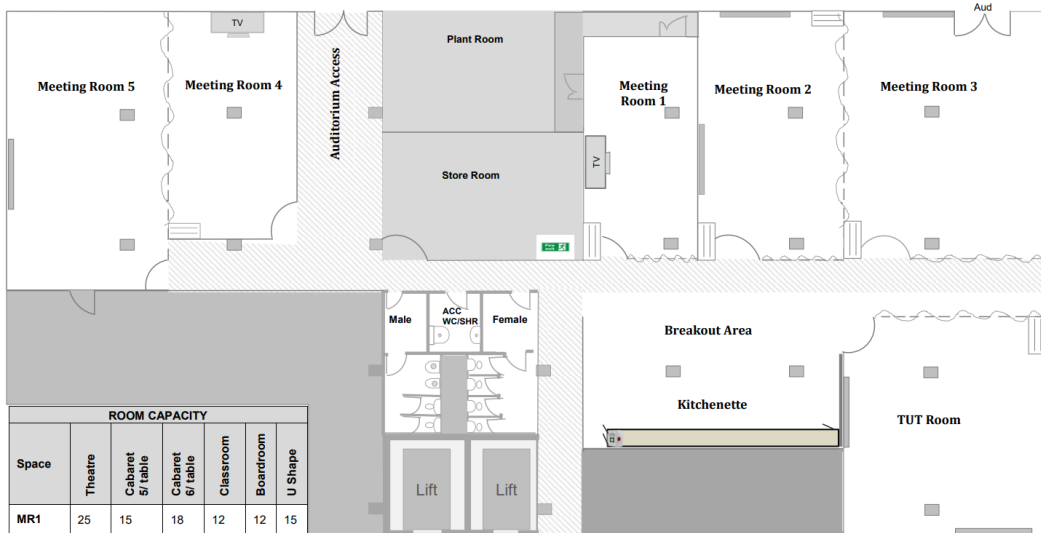

Space	ROOM CAPACITY				
	Theatre	Cabaret 5/ table	Cabaret 6/ table	Classroom	Boardroom U Shape
MR1	25	15	18	12	12
MR 2	40	20	24	9	14
MR 3	45	35	42	30	20
MR 2 + MR 3	100	60	72	36	20
MR 4	25	15	18	12	14
MR 5	40	30	36	24	21
MR 4 + MR 5	80	50	60	40	32
TUT ROOM	60	CABARET - 30 5/TABLE		30	21

Index			
	Convertible wall		Wall Panels
	Wooden Pillars		Doors
	Television		First Aid Kit
	Data Projector Screen		Auditorium Access